

VB150 Conference Camera

— **User Manual** —

Warning

Federal Communication Commission Interference Statement

NOTE: This equipment has been tested and found to comply with the limits for a Class A digital device, pursuant to part 15 of the FCC Rules. These limits are designed to provide reasonable protection against harmful interference when the equipment is operated in a commercial environment. This equipment generates, uses, and can radiate radiofrequency energy and, if not installed and used in accordance with the instruction manual, may cause harmful interference to radio communications. Operation of this equipment in a residential area is likely to cause harmful interference in which case the user will be required to correct the interference at his own expense.

FCC Caution: Any changes or modifications not expressly approved by the party responsible for compliance could void the user's authority to operate this equipment.

This device complies with part 15 of the FCC Rules.

The Operation is subject to the following two conditions:

- (1) This device may not cause harmful interference, and
- (2) this device must accept any interference received, including interference that may cause undesired operation.

This Class A digital apparatus complies with Canadian ICES-003. Cet appareil numérique de la classe A est conforme à la norme NMB-003 du Canada.

Warning

This is a class A product. In a domestic environment this product may cause radio interference in which case the user may be required to take adequate measures.

Caution

Risk of explosion if battery is replaced by an incorrect Type. Dispose of used batteries according to the Instructions.

PSTI Statement of Compliance

Please refer to the following website: <https://www.aver.com/product-security-advisory>

VCCI-A

この装置はクラス A 機器です。この装置を住宅環境で使用すると電波妨害を引き起こすことがあります。この場合には使用者が適切な対策を講ずるよう要求されることがあります。

(注) 本製品同梱の電源ケーブルは本製品同梱の電源アダプタでのみ使用してください。本製品同梱の電源ケーブルは他の電気機器では使用できません。

사 용 자 안 내 문

이 기기는 업무용 환경에서 사용할 목적으로 적합성평가를 받은 기기로서 가정용 환경에서 사용하는 경우 전자파간섭의 우려가 있습니다.

※ 사용자 안내문은 "업무용 방송통신기자재"에만 적용됩니다.

기종별	사용자안내문
A 급 기기 (업무용 방송통신기자재)	이 기기는 업무용(A 급) 전자파적합기기로서 판매자 또는 사용자는 이 점을 주의하시기 바라며, 가정외의 지역에서 사용하는 것을 목적으로합니다.

DISCLAIMER

No warranty or representation, either expressed or implied, is made with respect to the contents of this documentation, its quality, performance, merchantability, or fitness for a particular purpose. Information presented in this documentation has been carefully checked for reliability; however, no responsibility is assumed for inaccuracies. The information contained in this documentation is subject to change without notice.

In no event will AVer Information Inc. be liable for direct, indirect, special, incidental, or consequential damages arising out of the use or inability to use this product or documentation, even if advised of the possibility of such damages.

TRADEMARKS

"AVer" is a trademark owned by AVer Information Inc. Other trademarks used herein for description purpose only belong to each of their companies.

All HDMI trademarks and trade dress are registered trademarks or trademarks of HDMI Licensing Administrator, Inc.

COPYRIGHT

©2026 AVer Information Inc. All rights reserved. | April 2, 2026

All rights of this object belong to AVer Information Inc. Reproduced or transmitted in any form or by any means without the prior written permission of AVer Information Inc. is prohibited. All information or specifications are subject to change without prior notice.

More Help

For FAQs, technical support, software and user manual download, please visit:

Non-USA

Download Center: <https://www.aver.com/download-center>
Technical Support: <https://www.aver.com/technical-support>

USA

Download Center: <https://www.averusa.com/business/support/>
Technical Support: <https://averusa.force.com/support/s/contactsupport>

Contact Information

Headquarters

AVer Information Inc.
8F, No.157, Da-An Rd.,
Tucheng Dist., New Taipei City
236042, Taiwan
Tel: +886 (2) 2269 8535

USA Branch Office

AVer Information Inc., Americas
44061 Nobel Drive, Fremont,
CA 94538, USA
Tel: +1 (408) 263 3828
Toll-free: +1 (877) 528 7824

Europe Branch Office

AVer Information Europe B.V.
Westblaak 134, 3012 KM,
Rotterdam, The Netherlands
Tel: +31 (0) 10 7600 550

Japan Branch Office

アバー・インフォメーション株式会社
〒160-0023 日本東京都新宿区
西新宿 3-2-26 立花新宿ビル 7
階
Tel: +81 (0) 3 5989 0290
お客様サポートセンター(固定電
話のみ): +81 (0) 120 008 382

Vietnam Branch Office

Tầng 14, Tòa nhà Wings Tower,
380 Trần Hưng Đạo, Phường
Chợ Quán, Thành phố Hồ Chí
Minh, Việt Nam
Tel: +84 (0) 28 22 539 211
Hỗ trợ kỹ thuật: +84 (0) 90 70
080 77

Korea Office

한국 에버 인포메이션 (주)
서울시 종로구 새문안로 92
(신문로 1 가,
광화문오피시아빌딩) 1831,
1832 호
Tel: +82 (0) 2 722 8535

Contents

Warning	2
Overview	1
Package Contents	1
Optional Accessories	1
Parts Info	2
LED Indicator	3
Remote Control.....	4
Combination Buttons	5
Intallation	6
Wall Mount Installation.....	6
Screen Mount Installation (Optional)	8
TV VESA Mount Installation (Optional).....	9
Connections	12
Device Connection	12
Ethernet Connection	14
Expansion Microphone Installation (Optional).....	14
Get Started	15
Make a Video Call.....	15
Access the Web Interface.....	15
AVer Device Utility	15
Room Management.....	17
Log In for the First Time	18
Web Interface	19
PTZ Control	19

Add and Delete Available Presets (Presets 10-127).....	20
Setting.....	21
Overview of the Floating Live View	24
Tracking Mode.....	25
Video Format	27
Network.....	28
System.....	29
Audio.....	31
Room Management.....	32
Configure Settings on Room Management	32
EZLive	33

Overview

Package Contents



VB150

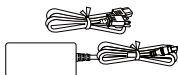

Power Adaptor &
Power Cord

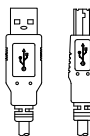

USB 2.0 Type-A to
Type-B Cable (5 m)



Remote Control

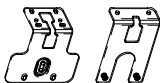

Wall Mount Kit



Tripod Screw
1/4"- 20UNC = 7.5 mm



USB Type-A to
Type-C Adapter

Optional Accessories



Expansion Microphone
10 m / 20 m (cable
included)

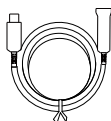

USB 3.1 Extender
10 m / 20 m / 30m



USB 3.1 Type-A to
Type-B Cable (3 m)



Screen Mount Kit

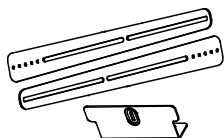

TV VESA Mount Kit



Tripod



Bluetooth® Dongle

* For details on optional accessories, please consult your local dealer.

Parts Info

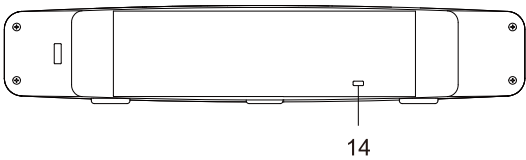
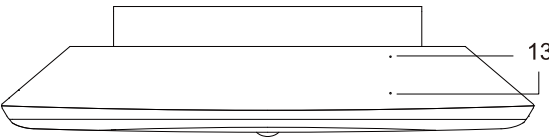
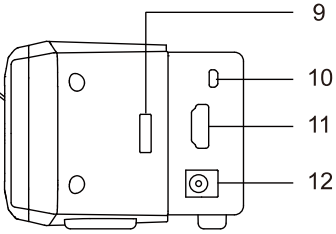
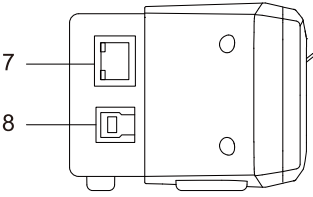
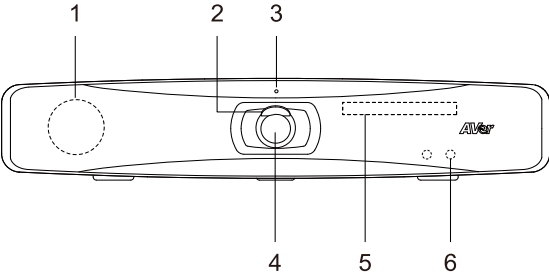

- 1. Speaker
- 2. Lens Cover
- 3. LED Indicator
- 4. Lens
- 5. Microphone Array
- 6. IR Sensor
- 7. Ethernet Port
- 8. USB 3.1 Type-B Port
- 9. Bluetooth® Dongle Port
- 10. Expansion Microphone Port
- 11. HDMI® Out Port
- 12. DC 12V Power Jack
- 13. Microphone Array
- 14. Kensington Lock

LED Indicator

Color	Status
Flashing blue once	Power on
Solid orange	Standby mode (not connected to USB device)
Solid white	Standby mode (connected to USB device) / a call on hold
Solid blue	Video/Audio on
Solid red	Mute
Solid purple	Video off but audio on (in-call)
Flashing current light	Calling
Flashing orange	Firmware update
Flashing orange twice	Reset

Remote Control

	Name	Function
1	Power	N/A
2	Camera Select	Select 1 to operate the camera. The remote control has been set to 1 at the factory. With each press, cycle through 1-5.
3	Number Buttons	<ul style="list-style-type: none"> To save a preset: Press and hold a Number (0-9). To load a preset: Press a Number (0-9).
4	Compound Key	Open compound keys guide. Refer to <Combination Buttons> for details.
5	SmartFrame	Press to frame entire group on screen. Press and hold to cycle through tracking modes. <ul style="list-style-type: none"> To hide the SmartFrame icon , go to Setting > On-Screen Menu > Off on the web interface or in Room Management.
6	Pan-Tilt Control	Pan and tilt direction control.
7	Back	N/A
8	Zoom In/Out	Zoom in or out.
9	Function Buttons	<ul style="list-style-type: none"> Join: Join a meeting. Pairing: Press and hold to turn Bluetooth® on. Press to disconnect. Manual Framing: N/A Leave: Leave a meeting. F1: Turn Audio Fence on or off. F2: Press and hold to switch between DHCP and Static IP F3 and F4: N/A
10	Menu	N/A
11	Load Preset	With each press, cycle through defined presets.
12	Audio Tracking	Press and hold to cycle through audio tracking modes.
13	Enter	Press to display current AI function on closed caption.
14	Mute	Mute or unmute microphone.
15	Camera Off	N/A
16	Volume	Volume up or down.

Combination Buttons

Press consecutively	To
Ⓟ + 0	Switch between 120° Wide Mode and 90° Depth Mode.
Ⓟ + 1	Turn wide dynamic range (WDR) on or off.
Ⓟ + 2	Turn Set Preset function on or off.
Ⓟ + 3	Turn RTMP streaming on or off.

Intallation

Wall Mount Installation

1. Use the drilling paper in the wall mount kit to drill four holes on the wall where the user wants to mount the camera. (Depending on different regions, it may include screen mount or wall mount kit in the package.)

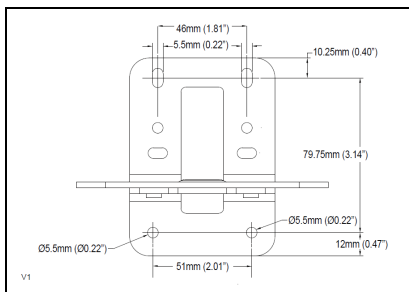

2. Use two M4 x8 screws in the wall mount kit to assemble L-mount brackets.

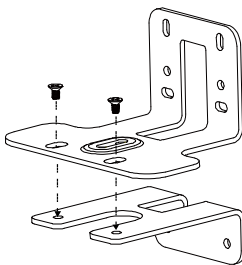

3. Use four screws (not supplied in the wall mount kit) to secure the L-mount brackets on the wall.

[Note]

Screws for Cement wall: M4 x20mm self-tapping screws (x4) + Plastic conical anchor

Screws for Wooden wall: M4 x20mm self-tapping screws (x4)

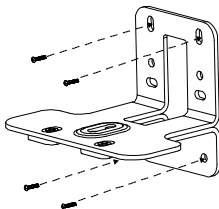

4. Pass the cables through the hole on the L-mount brackets and connect the cables to corresponding connection ports.

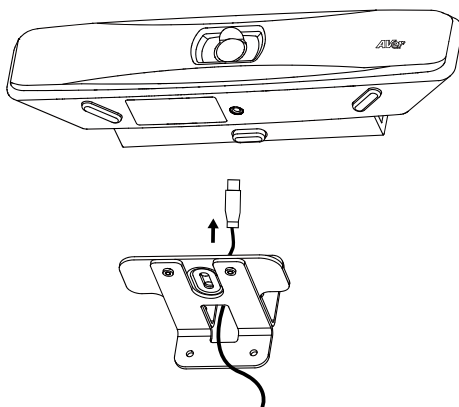

5. Use the tripod screw in the wall mount kit to secure VB150 on the L-mount brackets.

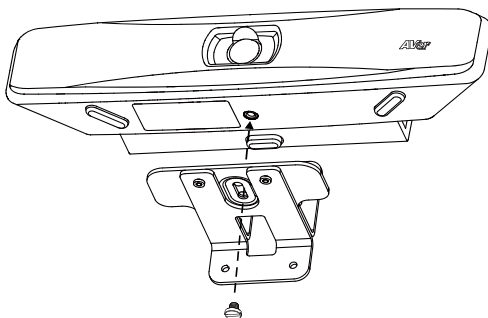

Screen Mount Installation (Optional)

1. Open the screen mount and use its tripod screw to secure the VB150. (Depending on different regions, it may include screen mount or wall mount kit in the package.)

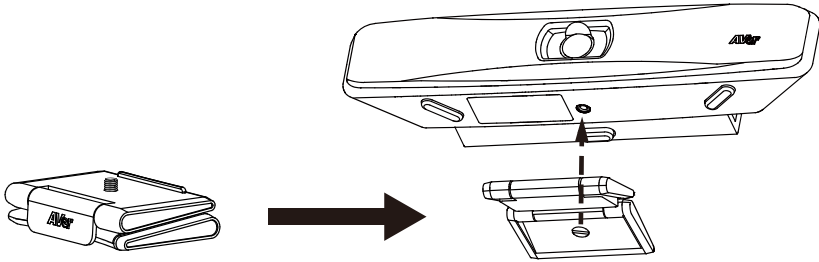

2. Clip the screen mount on the top of TV or the monitor. Tilt the screen mount if needed.

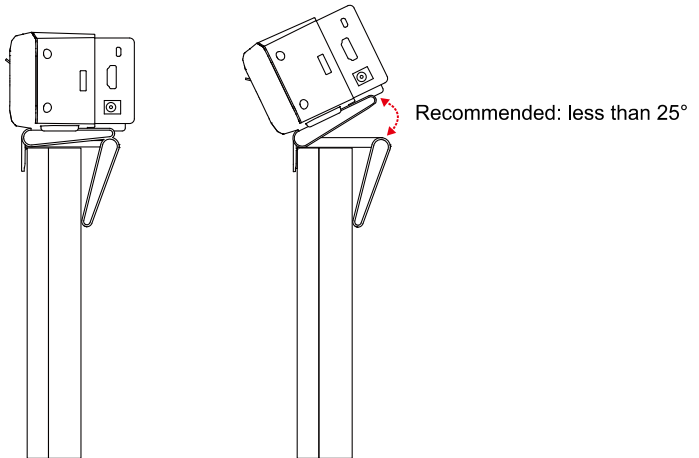

TV VESA Mount Installation (Optional)

1.

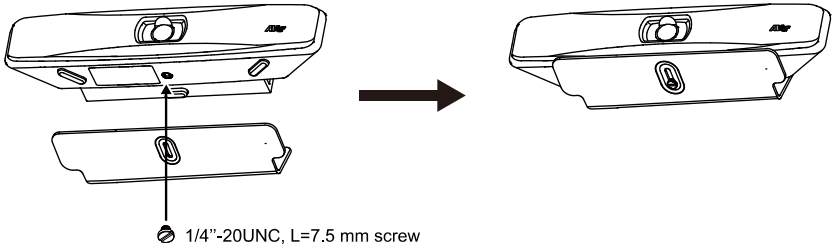

2.

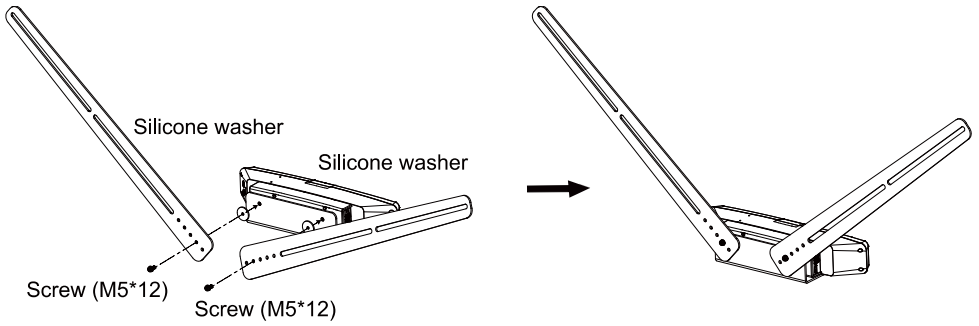

3.

Screw (M6*15) or
Screw (M6*20) or
Screw (M8*20) or
Screw (M8*30)

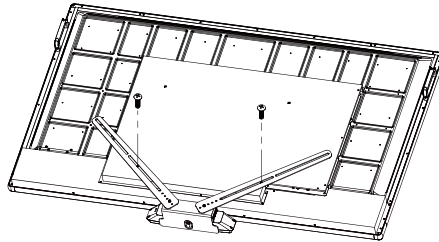

OR

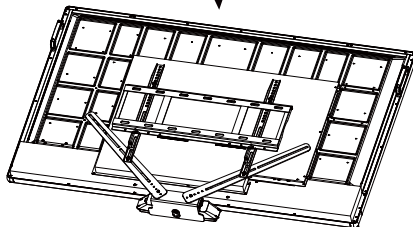
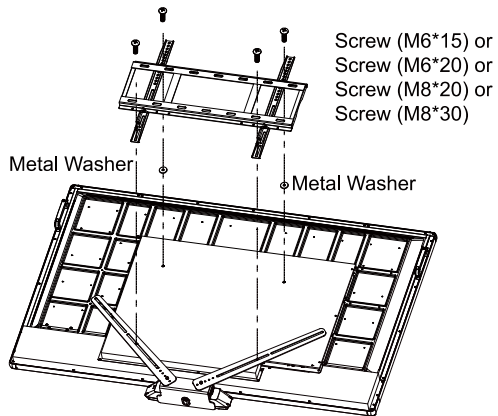

4.

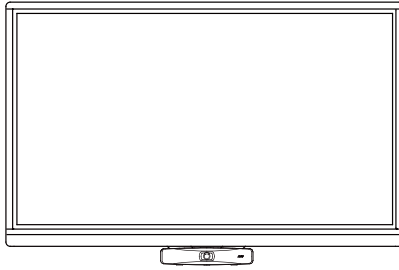

Connections

Device Connection

Computer

Connect the VB150 to a computer using the included USB 2.0 cable and connect the power cord of VB150 to power wall outlet.

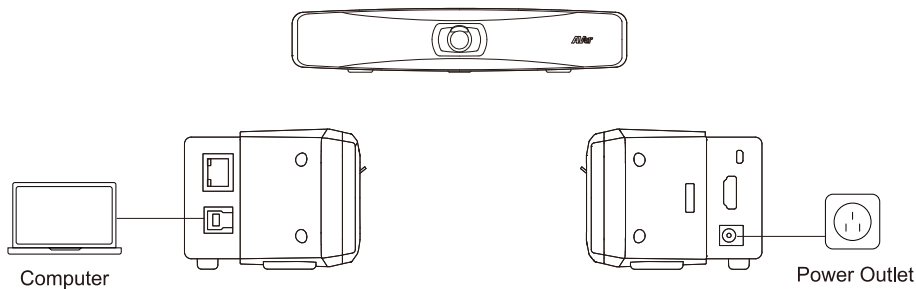

Resolution & frame rate for USB 2.0 and USB 3.1 connection:

USB 2.0		USB 3.1	
YUV	M-JPEG	YUV	M-JPEG
- 640x480 or less resolution, up to 30fps - 720p, up to 10fps	- Up to 4k/30fps - 1080p/60fps	- Up to 1080p/30fps - 720p/60fps	- Up to 4k/30fps - 1080p/60fps

Digital zoom ratio vs video resolution

Resolution	Zoom in/out ratio
4K	5x
1080p/60fps	5x
Others	5x

Phone

Plug the wireless dongle into the Bluetooth® dongle port before turning on VB150, then use the remote control or Room Management to turn on Bluetooth®.

Turn on Bluetooth® on the mobile phone to connect and use VB150 as an external microphone and speaker during conference meetings.

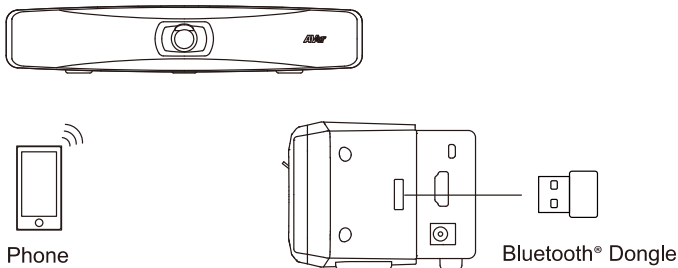

Make a three-way call:

While having a video call such as Zoom or Teams, user can use mobile phone to call third party to instantly join the on-going meeting. Connect a mobile phone to VB150 via Bluetooth connection. Use the mobile phone to call third party and the third party's sound can be heard by remote site to start a three-way conference call.

Ethernet Connection

Connect to Ethernet and access your camera's web interface.

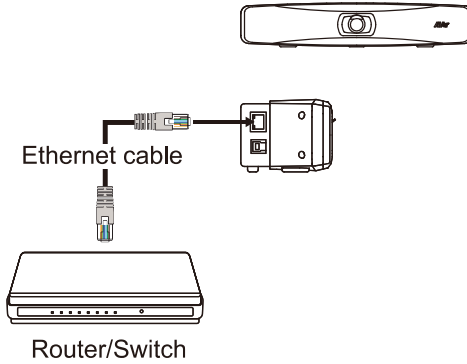

Expansion Microphone Installation (Optional)

Connect the expansion port on the video bar to the mini XLR port on the expansion microphone by using the included cable. The expansion speakerphone comes with a 10 m or 20 m cable.

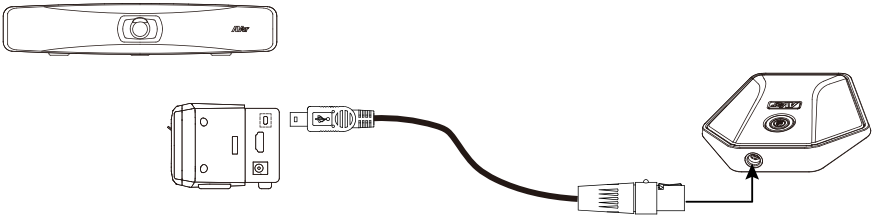

S

Get Started

Make a Video Call

The VB150 is a plug-n-play device. Open your video conferencing software and select the VB150 for **Audio and Video**.

Access the Web Interface

To access the web interface of your device, you can use any of the following software to find its IP address:

- AVer Device Utility
- Room Management

Note:

- The device's default network is DHCP.
- The device's default username/password is **admin/aver4321**.

AVer Device Utility

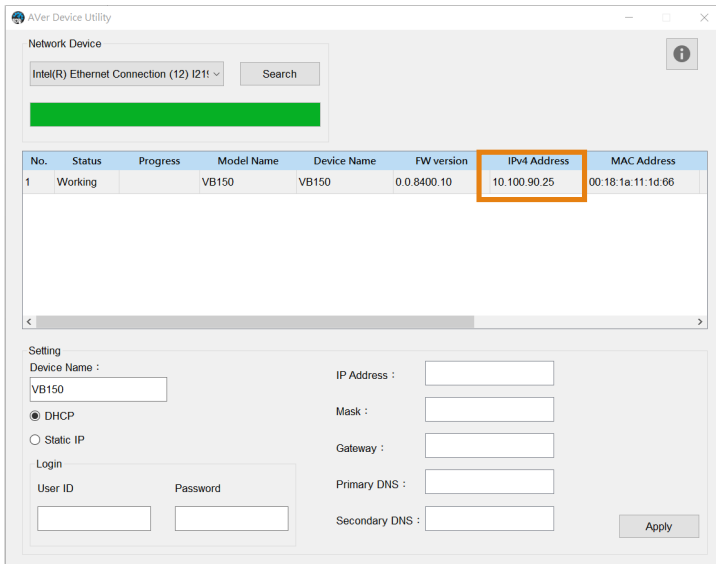

To access the web interface:

1. Download and install AVer Device Utility to your computer from AVer Download Center (<https://www.aver.com/download-center>) and launch the software.
2. Click **Search** to see available devices on the same local area network (LAN).

Note:

- Make sure your device is connected to the internet.
 - AVer Device Utility and your device must be on the same LAN.
3. Double-click on your device's IP address in the **IPv4 Address** column to open the web interface in your browser.

To change the network setting to DHCP or static IP:

1. Enter the default or changed password in the **Login** field.
2. Select **DHCP** or **Static IP**, then enter your network settings if applicable in the **Settings** section.
3. Click **Apply**.

Room Management

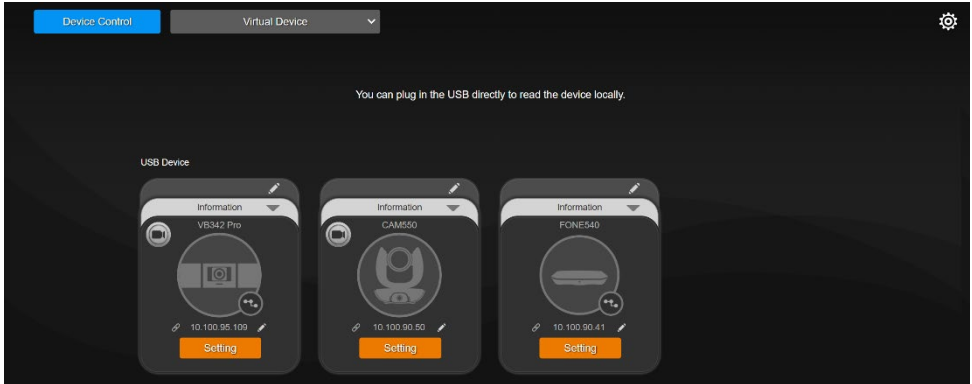

To access the web interface:

1. Download and install Room Management to your computer from AVer Download Center (<https://www.aver.com/download-center>) and launch the software.

Note:

- Make sure your device is connected to the internet.
 - Room Management and your device must be on the same LAN.
2. Connect your device to your computer with the included USB cable. Your device should appear under the **Device Control** page.
 3. Click **Setting** to control audio and video settings.
For additional information, please refer to the Room Management user manual.

To change the network setting to DHCP or static IP:

1. Click the **pencil icon**  on the device card.
2. Select **DHCP** or **Static IP**, then enter your network settings if applicable.
3. Click **Confirm**.

Log In for the First Time

When you log in for the first time, enter the default password **aver4321**. You will be prompted to set up a new account and password. The account and password cannot be the same.

- Account: Use 1-32 characters and a combination of uppercase letters, lowercase letters, numbers, and symbols (!\$%'()*+,-./<=>@[]^_}{~). The account name must not be "admin".
- Password: Use 8-32 characters and a combination of uppercase letters, lowercase letters, numbers, and symbols (!\$%'()*+,-./<=>@[]^_}{~).

Web Interface

PTZ Control

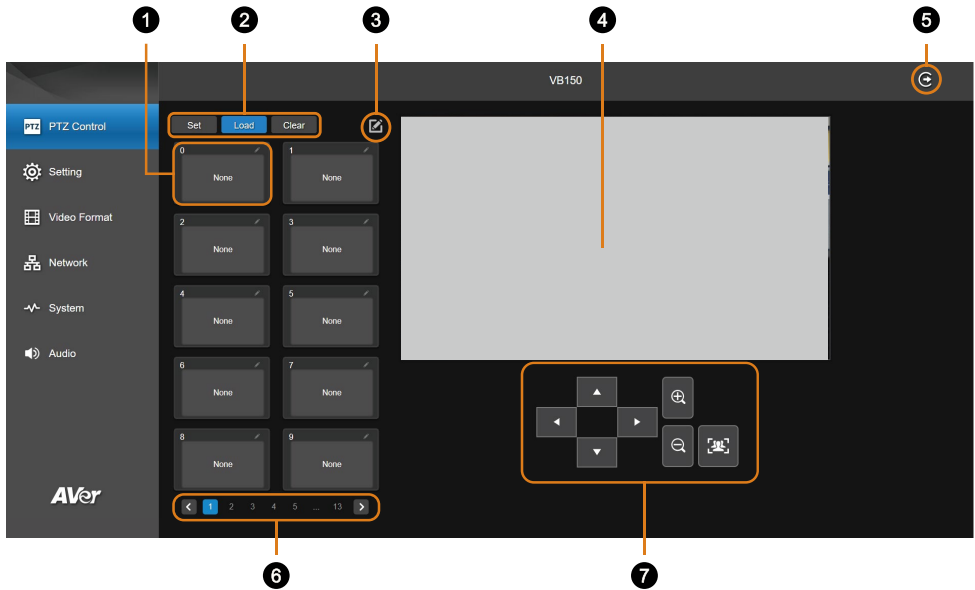

1. Preset Thumbnail

Click the pencil icon  to name a preset.

2. Preset Functions

3. Edit Presets

Add up to 128 or delete available presets.

4. Live View

5. Log Out

6. Pages of Available Presets

7. Directional Pad and Zoom

- SmartFrame  : Frame entire group on screen once.

Note: The SmartFrame icon  appears on video when turned on. To hide the icon, go to the **Setting** tab > **On-Screen Menu** > **Off** on the web interface.

Save, Load or Clear a Preset



To save, load or clear a preset:

1. Select an action you want: **Set**, **Load** or **Clear**.
2. Select a preset number.
3. Click **Yes** when prompted. A thumbnail will appear.

Add and Delete Available Presets (Presets 10-127)

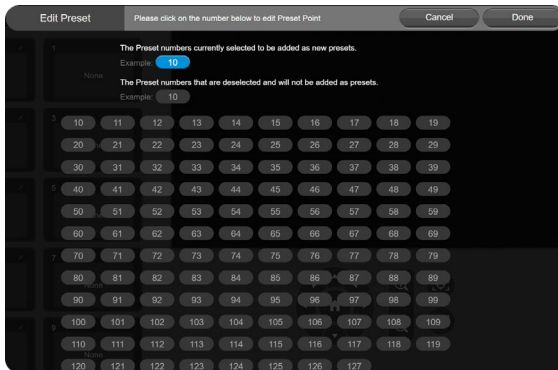

Presets 0-9 are available by default.

To add an available presets:

1. Click the **edit preset** icon.
2. Select the preset numbers you want to add. Selected presets will turn blue.
3. Click **Done**.

To delete an available preset:

1. Click the **edit preset** icon.
2. Select the preset numbers you want to delete. Selected presets will turn gray.
3. Click **Done**.

Setting

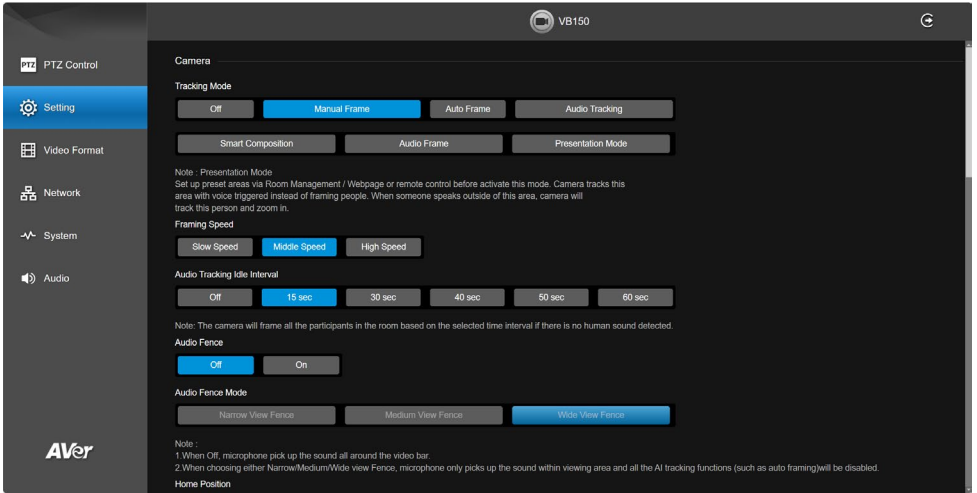

Camera

Item	Description
Tracking Mode	Select a tracking mode. Refer to < Tracking Mode > for details.
Framing Speed	Select a delay before auto frame. <ul style="list-style-type: none"> • Slow: 5 seconds before auto frame. • Middle: 3 seconds before auto frame. • High: 1 second before auto frame.
Audio Tracking Idle Interval	Select a delay for the camera to frame entire group after it detects no sound. <ul style="list-style-type: none"> • If Off is selected, the camera will stay at the last position.
Audio Fence	When Audio Fence is turned on: <ul style="list-style-type: none"> • Select a narrow or wide audio fence to capture only the voices within it. • You won't be able to use pan, tilt, zoom controls, SmartFrame.and tracking modes.
Audio Fence Mode	
Home Position	When the tracking mode is disabled, the camera will automatically

	<p>move to the preset position when powered on.</p> <p>When a tracking mode is enabled, the camera automatically starts tracking after power-on. If no person is detected, it switches to the panoramic view.</p>
On-Screen Menu	<p>Turn On-Screen Menu on or off / Call information.</p> <ul style="list-style-type: none"> • Off: Displays no icons or notifications. • On: Displays icons or notifications. • Load Preset Off: Displays all icons and notifications except load preset.
Save Preset	<p>Turn Save Preset on or off.</p> <ul style="list-style-type: none"> • When Save Preset is turned off, you won't be able to save presets using the remote control, web interface, hotkeys or VISCA commands.

Image

Item	Description
Field Of View	Two field of view options are available to fit different room sizes. Note: Turn off AI functions to enable this option.
Image Flip	Flip the image vertically.
Image Mirror	Flip the image horizontally.
True WDR	Turn True Wide Dynamic Range (WDR) on or off.
Frequency	Select a frequency.
White Balance	Select a white balance setting: <ul style="list-style-type: none">• Manual: Adjust the white balance manually by dragging the slider.• Auto White Balance (AWB): Adjust the white balance automatically.• Auto Tracking White Balance (ATW): Detect ambient lighting and adjust the white balance dynamically.
Noise Reduction	Select a noise reduction level.
Brightness	Select a brightness level.
Sharpness	Select a sharpness level.
Saturation	Select a saturation level.
Low Light Compensation	Turn Low Light Compensation on or off.
Low Resolution under 720p (except 848*480)	Enable to transmit video in 720p or lower.
Enlarge Total Zoom Up To 5x	Total zoom up to five times for detailed view.
Video Frame Rate	Select a video frame rate.

Overview of the Floating Live View

- The floating live views opens automatically in the **Setting**, **Video Format**, **Network** and **System** tabs.
- To open the floating live view again after closing, click on the camera icon on top of **Setting**, **Video Format**, **Network** and **System** tabs.

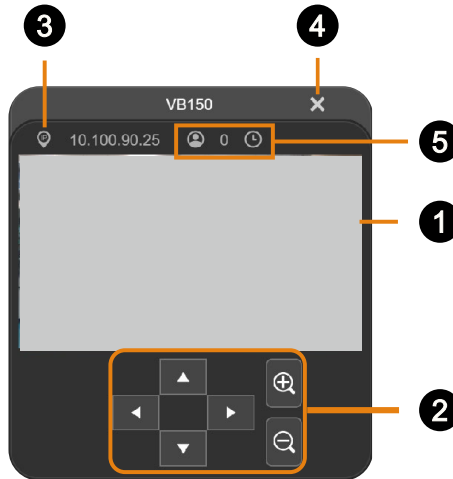

1. Live View

2. Directional Pad and Zoom

3. IP Address

4. Close

Click the X icon to close the floating live view and stop transmitting video.

5. Head Count and Video Transmission Duration

Click the head count icon to display head count and the duration of your video transmission. Click the icon again to hide the information.

Tracking Mode

Manual Frame

Frames manually using the SmartFrame button  to frame entire group on screen once.

Auto Frame

Frames entire group on screen automatically.

If no one is in view, the camera will default to preset 0.

- The camera auto frames every time a subject enters or leaves the screen.
 - If Auto Frame happens too frequently, set a delay before auto frame in the **Setting** tab > **Framing Speed**.
-

Audio Tracking

Frames active speaker on screen. After switching speakers three times, the camera frames all participants.

If no one is speaking, the camera will stay at the last position or default to group framing after your selected **Audio Tracking Idle Interval**.

- You can set a delay before the camera default to group framing in the **Setting** tab > **Audio Tracking Idle Interval**.
-

Smart Composition

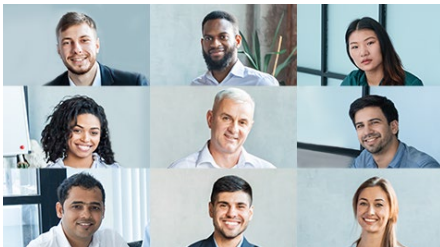

Creates a close-up frame for each participants and present them in a single stream composited gallery.

- Smart Composition frames up to 9 people. If more than 9 are in view, the camera will default to group framing.

Audio Frame

Frames active speaker on screen. After switching speakers three times, the camera frames all participants.

If no one is speaking, the camera will stay at the last position or default to group framing after your selected **Audio Tracking Idle Interval**.

- You can set a delay before the camera default to group framing in the **Setting** tab > **Audio Tracking Idle Interval**.

Presentation Mode

A combination of presets and Audio Tracking.

Uses presets when active speaker is speaking inside of presets; uses Audio Tracking and frames active speaker on screen when they are speaking outside of presets.

If no one is speaking, the camera will stay at the last position or default to group framing after your selected Audio Tracking Idle Interval.

- Make sure you have defined presets for audio tracking. Presets 1-9 are available. Preset 0 defaults to the home position.
- You can set a delay before the camera default to group framing in the **Setting** tab > **Audio Tracking Idle Interval**.

Video Format

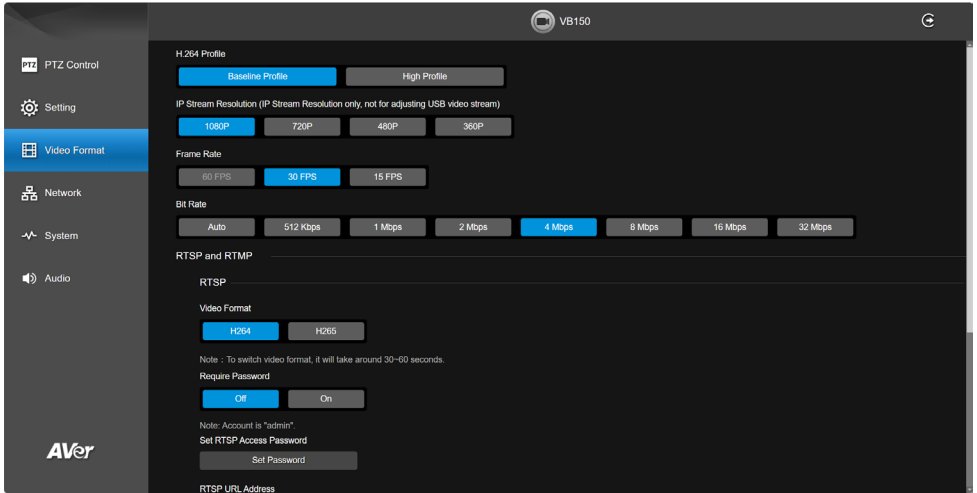

Item	Description
H.264 Profile	Select a profile for streaming live.
IP Stream Resolution	Select a resolution for streaming over IP.
Frame Rate	Select a frame rate.
Bit Rate	Select a bit rate. <ul style="list-style-type: none"> To live stream on Facebook, we recommend a bit rate under 4Mbps.

RTSP and RTMP

Item	Description	
RTSP	Video Format	Select a video format.
	Require Password	Turn Require Password on or off.
	Set RTSP Access Password	Set or change an RTSP access password.
	RTSP URL Address	Displays RTSP URL address.
RTMP	Server URL	Copy and paste your video platform's server URL and stream key.
	Stream Key	
	Start Using RTMP	Click Start to start streaming, Stop to stop streaming.

Network

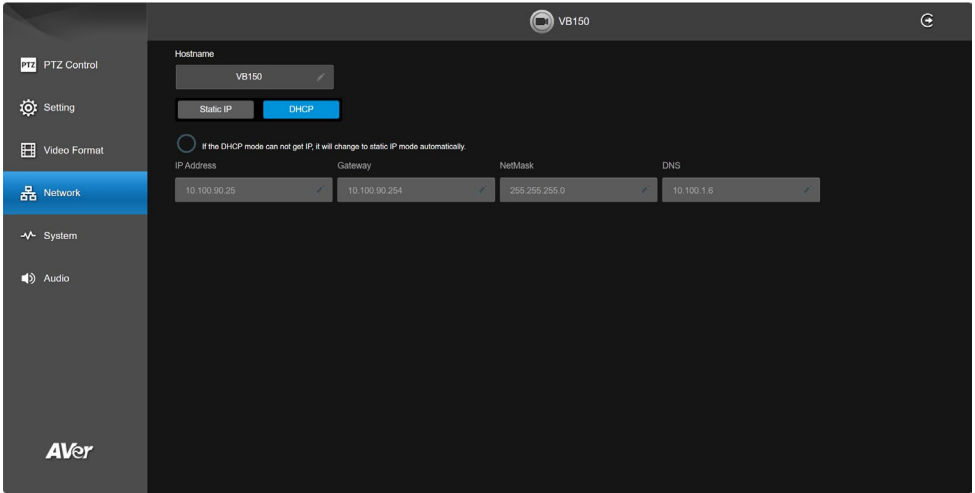

Item	Description
Hostname	Click the pencil icon to edit a hostname. Use upper and lowercase letters and numbers.
Static IP, DHCP	Set the network setting to Static IP or DHCP. <ul style="list-style-type: none"> • Static IP: Enter your network settings to set up a static IP connection and click Confirm. • DHCP (default): The DHCP server assigns a random IP automatically.

System

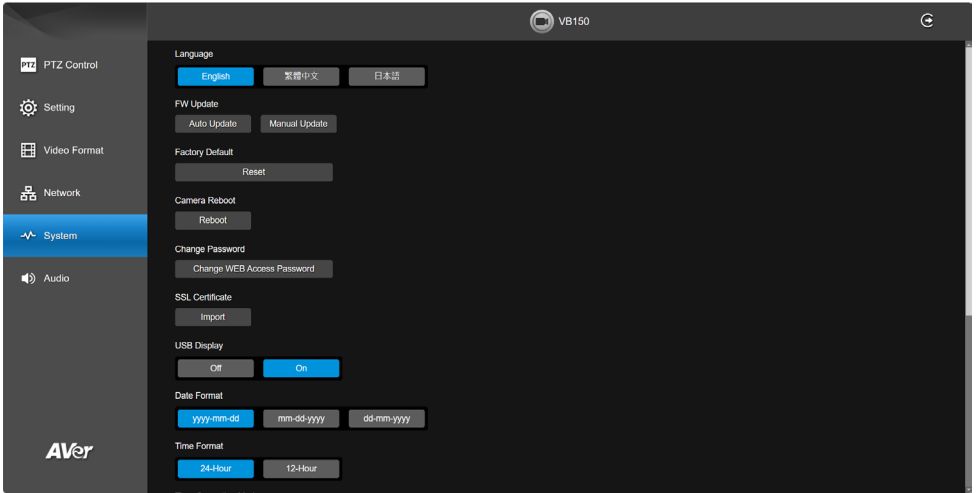

Item	Description
Language	Select a language for the web interface.
Firmware Update	Update your camera's firmware. <ul style="list-style-type: none"> • Auto Update: Checks and updates online. • Manual Update: Update the firmware using a file offline. <p>Note: The camera will reboot and the connection will be lost. Please wait a few minutes and keep the power cable connected. Unplugging the cable during this process may damage the device.</p>
Factory Default	Reset your camera to factory default settings. You can choose to keep the IP address by selecting the checkmark. <ul style="list-style-type: none"> • If you forgot your password, use Room Management to reset the web interface password to the default aver4321.
Camera Reboot	Reboot the camera.
Change Password	Change the web interface password. Refer to <Log In for the First Time> . <ul style="list-style-type: none"> • If you forgot your password, use Room Management to reset the web interface password to the default aver4321.
SSL Certificate	Upload an SSL certificate.
USB Display	The HDMI output port supports USB display. Turn USB display on or off.
Date Format	Select a date format.
Time Format	Select a time format.
Time Correction Mode	Select a time correction mode.

	<ul style="list-style-type: none"> • Auto: Enter your Network Time Protocol (NTP) server URL to synchronize the clock. The default NTP server is located in the US. • Manual: Click the pencil icon to set up the clock.
Allow Providing of Anonymous Usage Data	Opt-in or opt-out of providing usage data.
Information	Displays your camera information such as IP address.

Audio

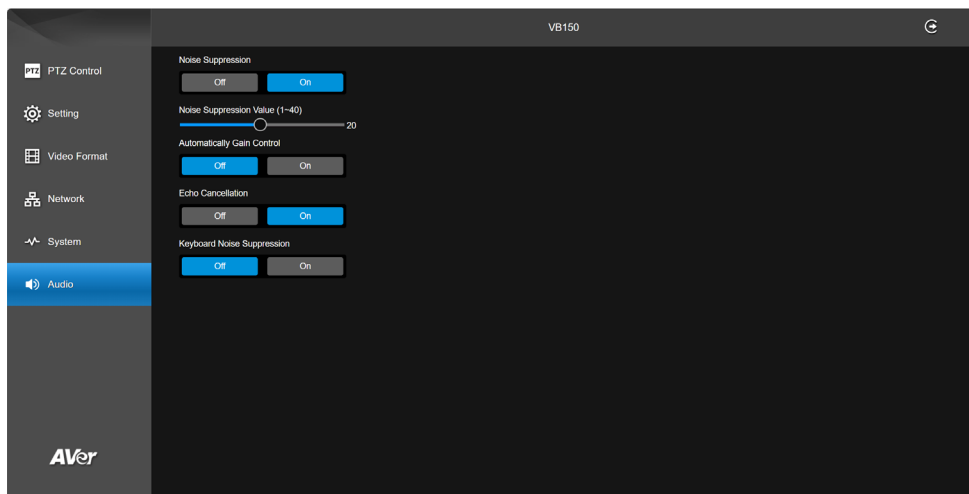

Item	Description
Nosie Suppression	Reduce ambient noise. Adjust the noise suppression value by dragging the slider.
Automatically Gain Control	Turn automatic gain control on or off.
Echo Cancellation	Reduce echoes.
Keyboard Noise Suppression	Turn keyboard noise suppression on or off.

Room Management

Configure Settings on Room Management

1. Download and install Room Management to your computer from AVer Download Center. (<https://www.aver.com/download-center>) and launch the software.
2. Connect your device to your computer using the included USB cable. Your device should appear under the **Device Control** page.
3. Click **Setting** to control audio and video settings.
For additional information, please refer to the Room Management user manual.

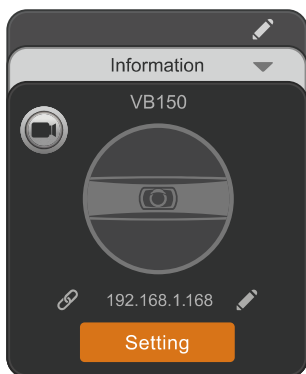

EZLive

Please go to <https://www.aver.com/download-center> to download the AVer EZLive software. After downloading, double-click on the file and follow the on-screen instructions to complete the installation.

During a video call, EZLive can help user to do:

- (1) Camera ePTZ
- (2) Volume control for the speaker connected
- (3) Capture camera's still images
- (4) Record video
- (5) Live stream to YouTube, Livehouse.in, USTREAM, etc.
- (6) Camera Zoom in/out
- (7) Capture PC screen shot
- (8) Record PC screen video
- (9) Set up livestream
- (10) Open file management to retrieve photos and video files
- (11) Livestream setting
- (12) Drawing tool.

